

✱ STANCHION AND CHAINS TO BE IN PLACE BEFORE CROSSING PLATFORM BEGINS

** THIS LAYOUT IS SUBJECT TO CHANGE AS REQUIRED

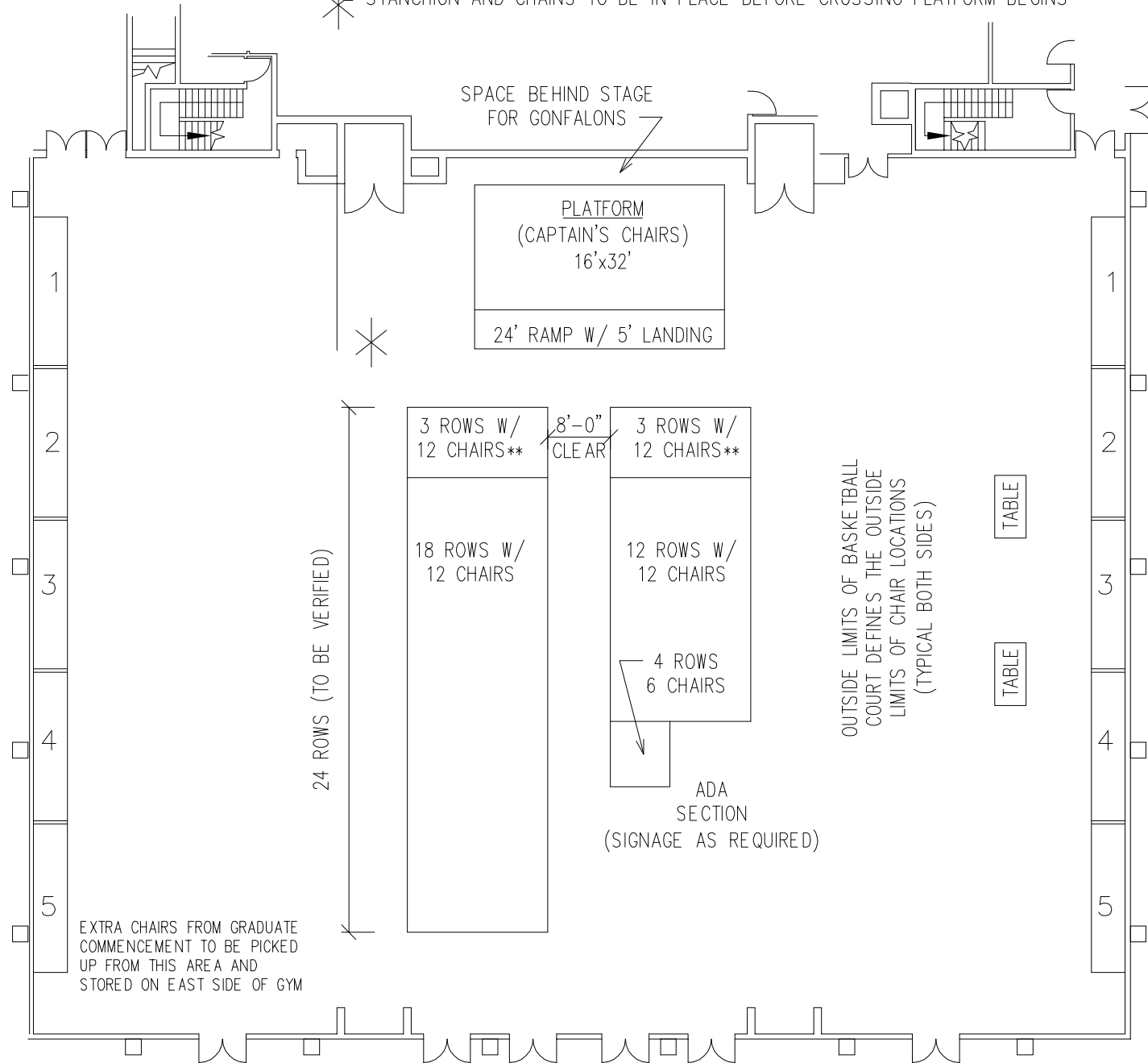

** THESE ROWS ARE RESERVED FOR FACULTY

AVAILABLE SEATING
FACULTY : 72
STUDENTS AND GUESTS:
495 + ADA AREA

DATE: 05/16/05

2005 SPRING CONVOCATION - FOLEY GYMNASIUM - PE CENTER

SHEET

FILE: GRD_CON

SCALE: N.T.S.

PHYSICAL PLANT
PLYMOUTH STATE UNIVERSITY - PLYMOUTH, NH

PSU-1